

Floor Guide

Kyoto International Conference Center

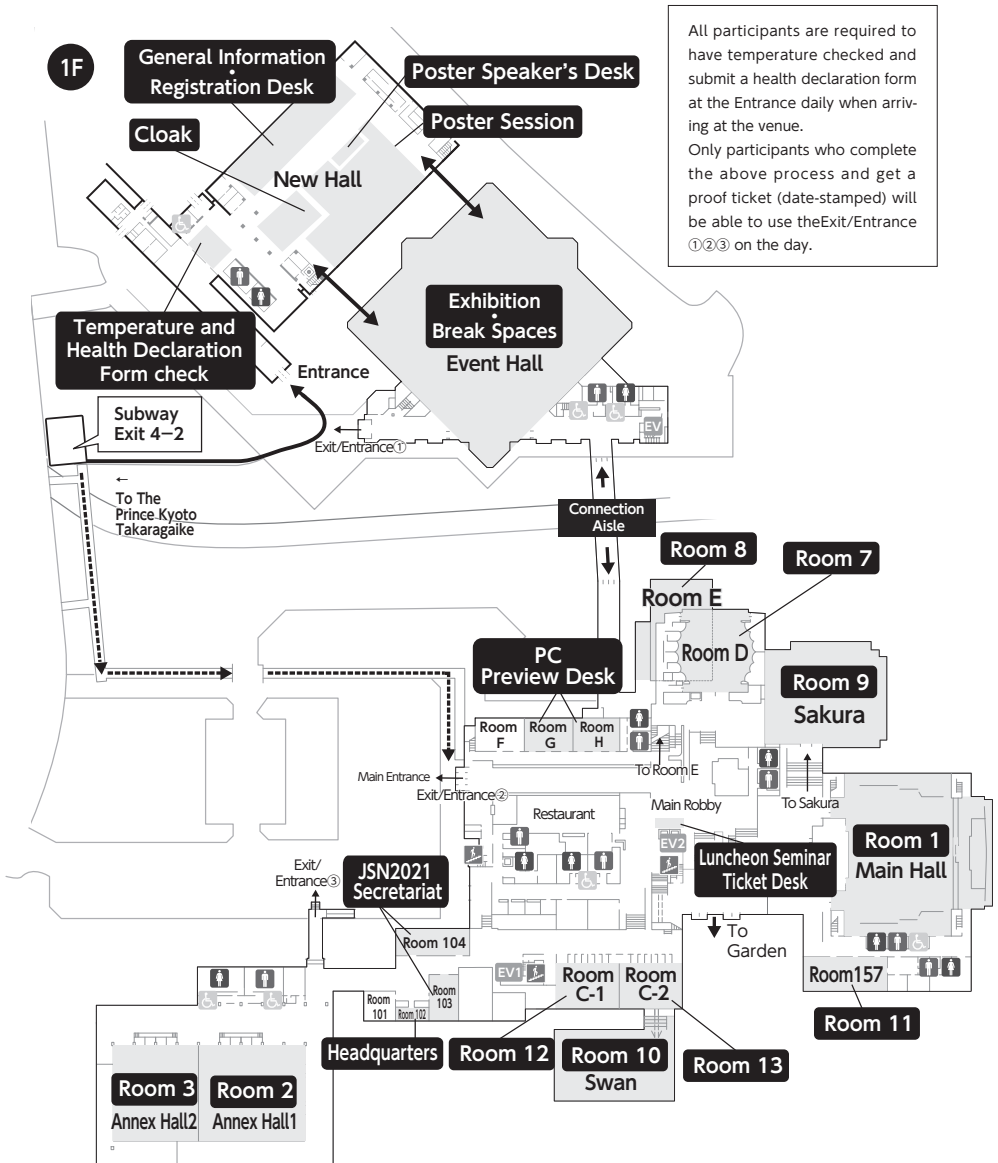

All participants are required to have temperature checked and submit a health declaration form at the Entrance daily when arriving at the venue. Only participants who complete the above process and get a proof ticket (date-stamped) will be able to use the Exit/Entrance ①②③ on the day.

Floor Guide

Kyoto International Conference Center

2F

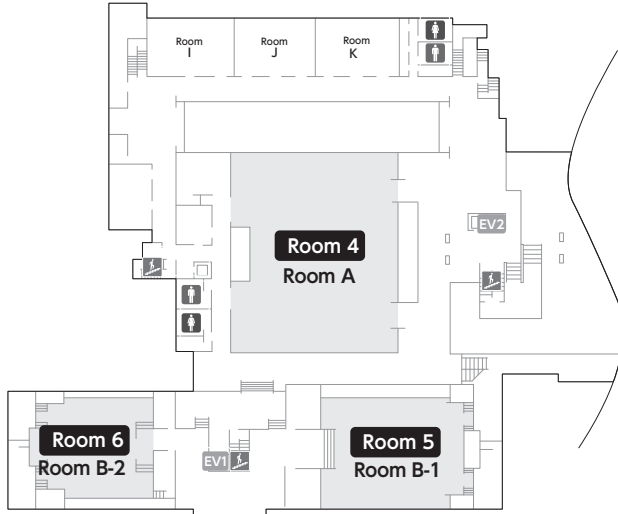

5F

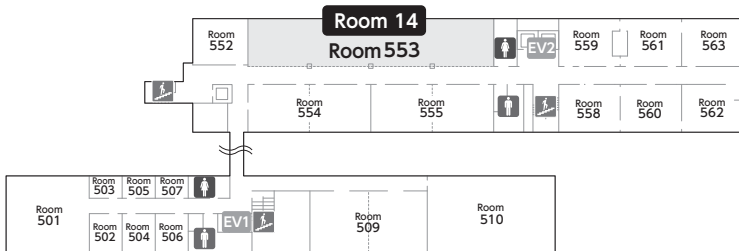

6F

